

3.96mm(.156") HOUSING

MATERIAL

Insulator: Nylon 66 UL 94V-0
Color: White

SPECIFICATIONS

Temperature range: -25°C ~ +120°C
Current rating: 7.0A
Voltage rating: 250V AC
Dielectric withstand voltage: 800V AC
Insulation resistance: 1000 MΩ Min.
Accepts S.Y.E. R3953 Terminal

Order Information

R 3950-xxP
1 2 3

1. RoHS
2. Series No.
3. Pin No.

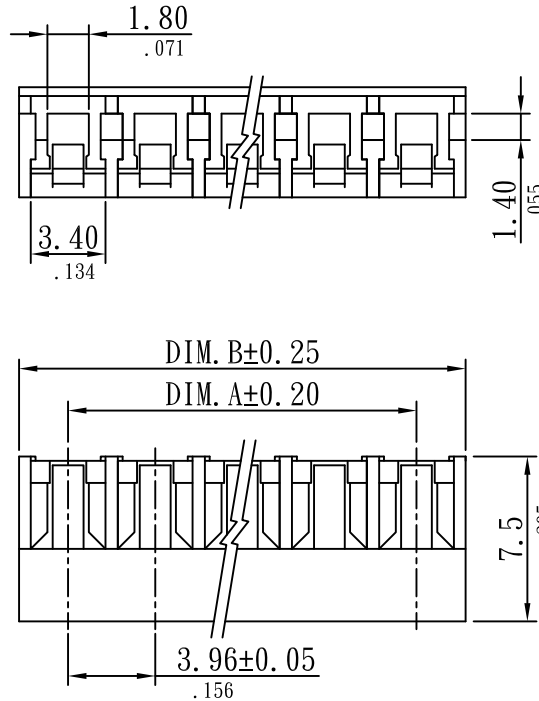

Dimensional Information

Circuits	DIM. A		DIM. B		Circuits	DIM. A		DIM. B	
	mm	in	mm	in		mm	in	mm	in
2	3.96	0.156	8.42	0.331	9	31.68	1.247	36.14	1.423
3	7.92	0.312	12.38	0.487	10	35.64	1.403	40.10	1.579
4	11.88	0.468	16.34	0.643	11	39.60	1.559	44.06	1.735
5	15.84	0.624	20.30	0.799	12	43.56	1.715	48.02	1.891
6	19.80	0.780	24.26	0.955	13	47.52	1.871	51.98	2.046
7	23.76	0.935	28.22	1.111	14	51.48	2.027	55.94	2.202
8	27.72	1.091	32.18	1.267	15	55.44	2.183	59.90	2.358



Sunny Young Enterprise Co., Ltd.

S. Y. E. <http://www.sunnyyoung.com.tw>

13F., No. 116, Sec. 1, Xintai 5th Rd., Xizhi Dist., New Taipei City 221, Taiwan

Tel: +886 2 2696 1668(REP) Fax: +886 2 2696 2668

PART NO

R3950-xxP

T013	NAME	DATE	SCALE: NTS	REV NO	DATE	DESCRIPTION	BY	CHECKED	TOLERANCE UNLESS NOTED	
DRAWN	YXF	2009.03.20	UNIT: mm(in.)	A					LINEAR±	.0 ±0.25(.010)
CHECKED	PIQI	2009.03.20	CAD NO	B						.00 ±0.15(.006)
APPROVED	PC	2009.03.20	R3950-xxP	C						.000±0.08(.003)
									PROJECTION:	

3.96mm(.156") TERMINAL

SPECIFICATION

Material : Brass
 Thickness : 0.25mm
 Plating: Tin plated
 Applicable wire: AWG 16 ~ AWG 22
 Insulation O.D. : 3.10mm Max.

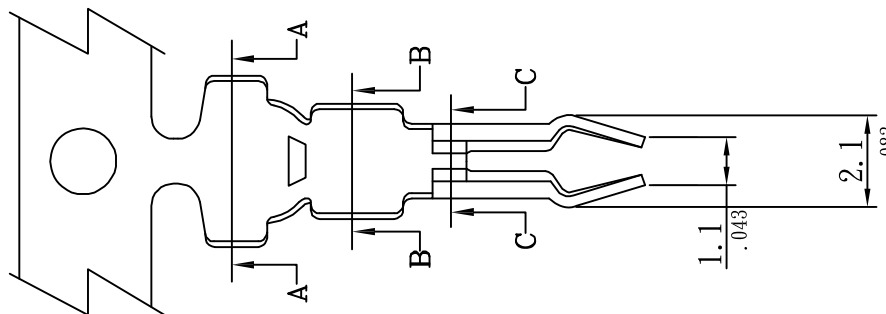

R 3953-B T
 1 2 3 4

1. RoHS
2. Series No.
3. Brass
4. Tin plated

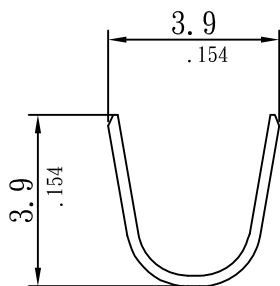

SECTION A-A

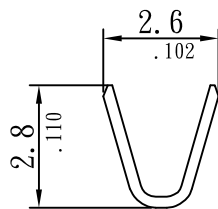

SECTION B-B

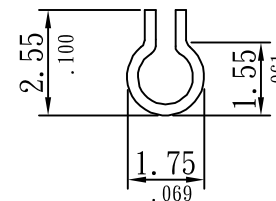
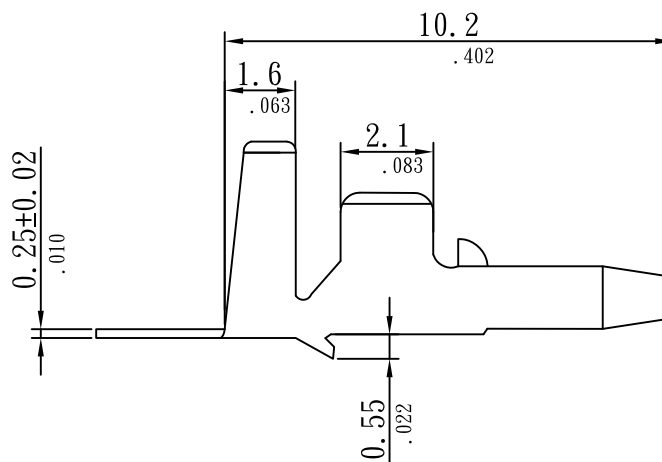

SECTION C-C



Sunny Young Enterprise Co., Ltd.

S. Y. E. <http://www.sunnyyoung.com.tw>

13F., No. 116, Sec. 1, Xintai 5th Rd., Xizhi Dist., New Taipei City 221, Taiwan

Tel: +886 2 2696 1668(REP) Fax: +886 2 2696 2668

PART NO

R3953-BT

T013	NAME	DATE	SCALE: NTS	REV NO	DATE	DESCRIPTION	BY	CHECKED	TOLERANCE UNLESS NOTED	
DRAWN	SU	2012. 08. 29	UNIT: mm(in.)	A					LINEAR±	.0 ±0.25(.010)
CHECKED	ALBERT	2012. 08. 29	CAD NO	B				.00 ±0.15(.006)		
APPROVED	TINA	2012. 08. 29	R3953-BT	C						.000±0.08(.003)

PROJECTION: