

# 2.54mm(.100") PIN HEADER

## MATERIAL

Insulator: PBT+GF UL 94V-0  
 Color: Black(Standard)  
 Contact: Brass 0.64mm(.025") square pins  
 Plating: Gold plated , Tin plated

## SPECIFICATIONS

Temperature range: -25°C ~ +85°C  
 Current rating: 3.0A  
 Voltage rating: 250V AC  
 Dielectric withstand voltage: 500V AC  
 Insulation resistance: 1000 MΩ Min.  
 Contact resistance: 0.02 Ω Max.

## Order Information

R 1100 xx x R xxx x S xxx x xx  
 1 2 3 4 5 6 7 8 9 10 11

- 1. RoHS
- 2. Series No.
- 3. Pin No.
- 4. Plating: C:C TYPE  
G:Gold plated  
T: Tin plated
- 5. R:Right angle
- 6. Top End length
- 7. Color: A:Black(Standard)  
J:White
- 8. S:Single stack
- 9. Total length
- 10. TYPE: F:F TYPE
- 11. Serial No.

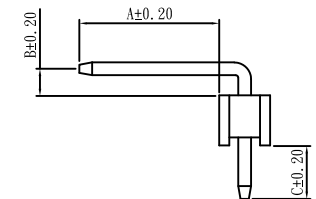
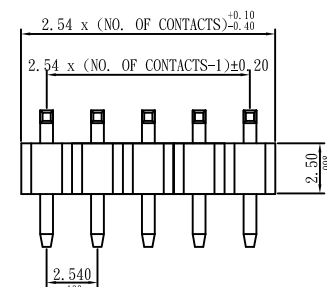
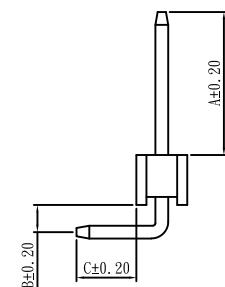
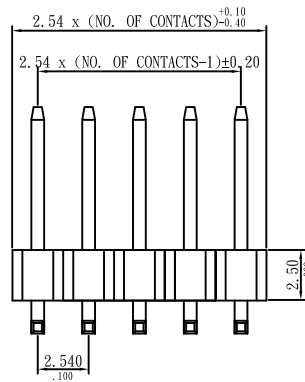
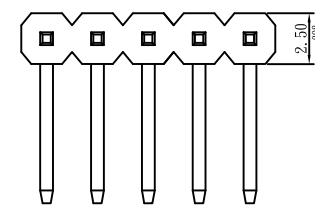
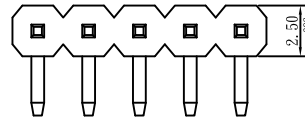

C TYPE

F TYPE

**Sunny Young Enterprise Co., Ltd.**  
 S. Y. E. <http://www.sunnyyoung.com.tw>  
 13F., No. 116, Sec. 1, Xintai 5th Rd., Xizhi Dist., New Taipei City 221, Taiwan  
 Tel:+886 2 2696 1668(REP) Fax:+886 2 2696 2668

M111	NAME	DATE	SCALE: NTS	REV NO	DATE	DESCRIPTION	BY	CHECKED	TOLERANCE UNLESS NOTED	
DRAWN	RALF	2020. 11. 12	UNIT: mm(in.)	A					LINEAR±	.0 ±0.30(.012)
CHECKED	DEAN	2020. 11. 12	CAD NO	B						.00 ±0.20(.008)
APPROVED	APPLE	2020. 11. 12	R1100 90° Series	C						.000±0.10(.004)

PART NO R1100 90° Series

PROJECTION:

# 2.54mm(.100") PIN HEADER

## MATERIAL

Insulator: PBT+GF UL 94V-0  
 Color: Black(Standard)  
 Contact: Brass 0.64mm(.025") square pins  
 Plating: Gold plated , Tin plated

## SPECIFICATIONS

Temperature range: -25°C ~ +85°C  
 Current rating: 3.0A  
 Voltage rating: 250V AC  
 Dielectric withstand voltage: 500V AC  
 Insulation resistance: 1000 MΩ Min.  
 Contact resistance: 0.02 Ω Max.

## Order Information

R 1100 xx x S xxx x S xxx  
 1 2 3 4 5 6 7 8 9

- |                    |                   |
|--------------------|-------------------|
| 1. RoHS            |                   |
| 2. Series No.      | 6. Top End length |
| 3. Pin No.         | 7. Color:         |
| 4. Plating:        | A:Black(Standard) |
| G:Gold plated      | J:White           |
| T:Tin plated       | 8.S:Single stack  |
| 5.S:Straight angle | D:Double stack    |
|                    | 9.Total length    |

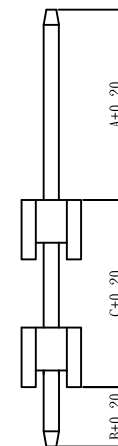
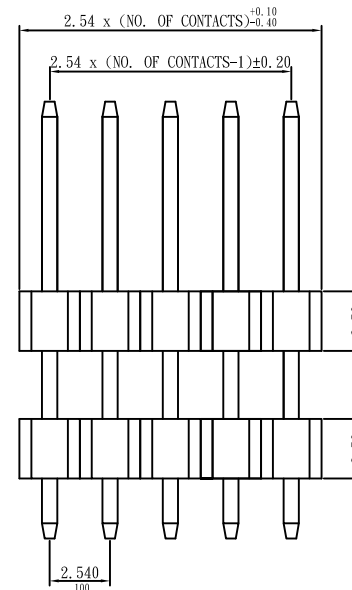
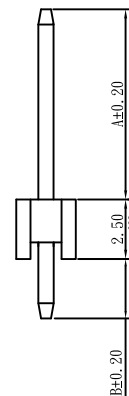
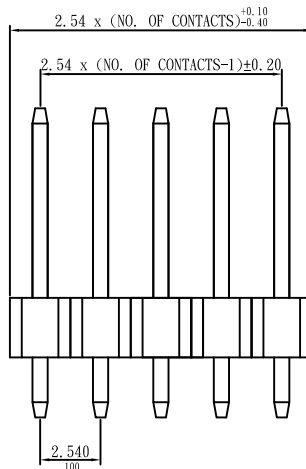
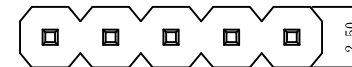

**S.Y.E.** Sunny Young Enterprise Co., Ltd.  
 S. Y. E. <http://www.sunnyyoung.com.tw>  
 13F., No. 116, Sec. 1, Xintai 5th Rd., Xizhi Dist., New Taipei City 221, Taiwan  
 Tel:+886 2 2696 1668(REP) Fax:+886 2 2696 2668

M111	NAME	DATE	SCALE: NTS	REV NO	DATE	DESCRIPTION	BY	CHECKED	TOLERANCE UNLESS NOTED	
DRAWN	RALF	2020.11.12	UNIT: mm(in.)	A					LINEAR±	.0 ±0.30(.012)
CHECKED	DEAN	2020.11.12	CAD NO	B				.00 ±0.20(.008)		
APPROVED	APPLE	2020.11.12	R1100 180° Series	C				.000±0.10(.004)		
PART NO		R1100 180° Series						PROJECTION:		